



Instructions

JEEP GRAND CHEROKEE (WL) - MASS STORAGE PLATFORM

Thank you for purchasing your Jeep WL MASS Storage Platform from AAL! We greatly appreciate your trust in our company. We take that purchase and your commitment to us very seriously. If you have any questions along the way, please don't hesitate to give us a call at 385.202.4188.

****Please read these instructions thoroughly before starting this project.****

****This platform is designed for 2022-Current standard size WLs and will NOT fit the "L" models ****



NOTE: This platform will be set into the vehicle as an assembled unit. It is strongly recommended that you enlist the help of an assistant!

Tools Required:

There is more than one tool for every job, but below is the list of tools we use for this installation.

- M2.5 Allen Wrench/Socket
- M4 Allen Wench/Socket
- M5 Allen Wrench/Socket
- T45 Torx Wrench/Socket
- 10mm Deep Well Socket
- 7mm Wrench
- 8mm Wrench
- 10mm Wrench
- 19mm Wrench
- Phillips Head Screwdriver
- Flathead Screwdriver or Panel Tool

Hardware Included:

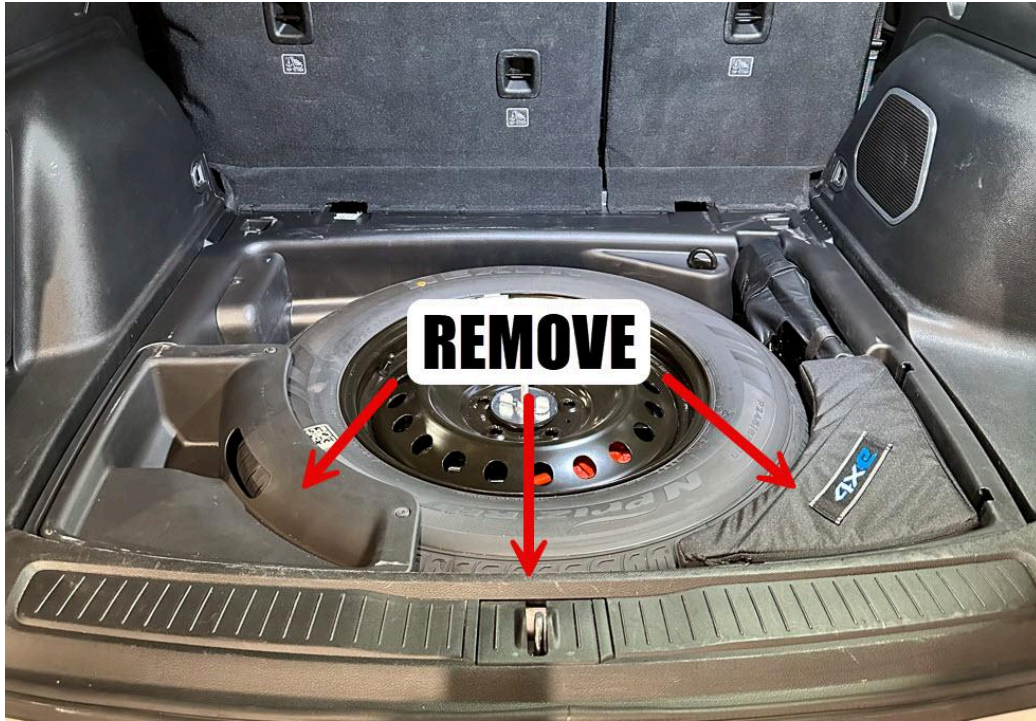
M4x14mm Flat Head Bolts	24	M6 Nylock Nuts	21
M4 Nylock Nuts	24	M8x20mm Button Head Bolts	2
M6x8mm Flat Head Bolts	34	#8x1.5in Phillips Head Screws	2
M6x8mm Button Head Bolts	12	M8 Hex Stand Off Nuts	2
M6x14mm Button Head Bolts	21	Latch Assemblies	2
		Piano Hinge	1

****It is strongly suggested to lay out all hardware before starting this installation.****

Step 1 - Teardown

First things first, remove the carpet spare tire cover, spare tire tub(s), and charging cable bag (if applicable). Once removed, using a flathead screwdriver or panel tool, remove the factory hatch latch trim panel. See *image 1* for identification.

Image 1



Next, at the front of the cargo area, using a T45 Torx socket, and a phillips head screwdriver, remove the tie down loop bolts, the tie down loops, and the phillips head screws that are holding down the front of the cargo tray. See *image 2* for reference. *You will not be reusing these pieces.*

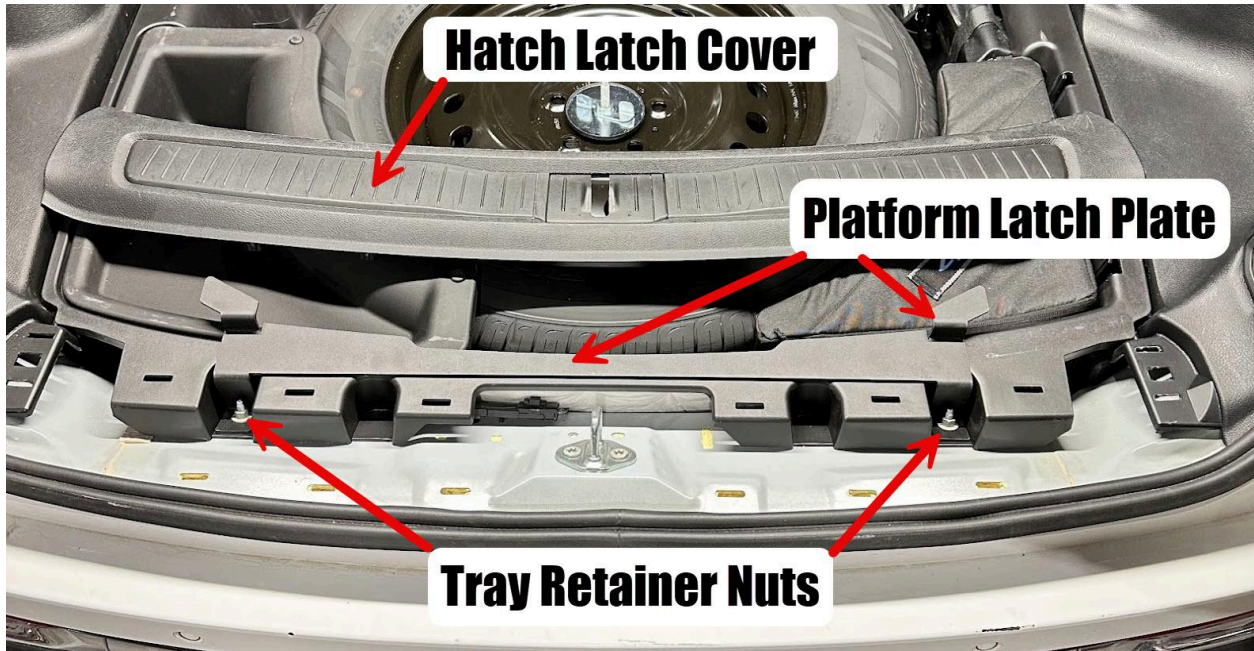
Image 2



Step 2 - Install Platform Latch Plate

Now that everything has been removed, we can install the Platform Latch Plate. To do so, remove the (2) 10mm nuts holding down the Cargo Tray, and install the Platform Latch Plate over the studs as shown in image 3. Reinstall the (2) retaining nuts, tighten, and reinstall the Hatch Latch Cover.

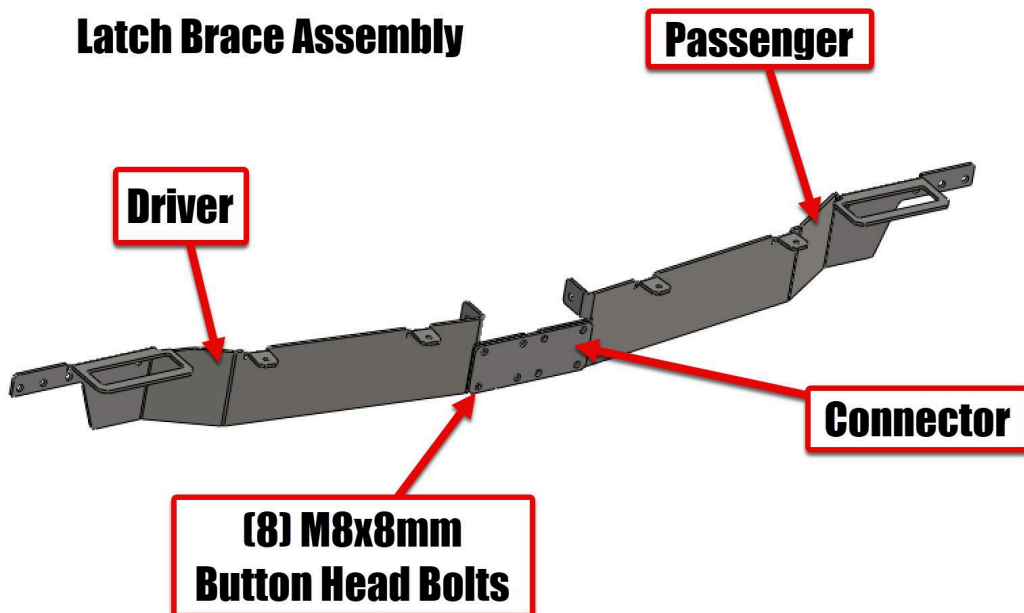
Image 3



Step 3 - Platform Structure Assembly

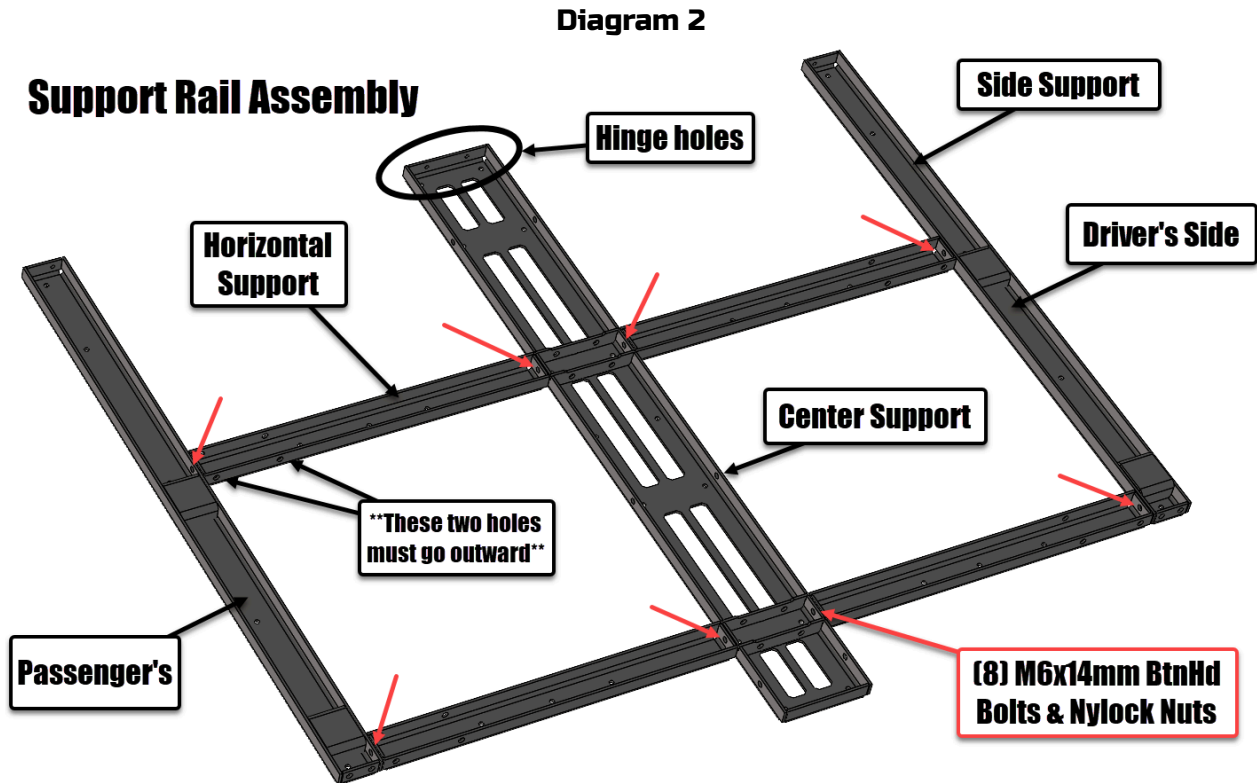
It is now time to put together the platform structure assembly. We'll start with the Latch Brace Assembly. Locate the Driver and Passenger Latch Braces and the Latch Brace Connector along with (8) M6x8mm Button Head Bolts. Assemble these components as shown in diagram 1. Set aside and move on.

Diagram 1

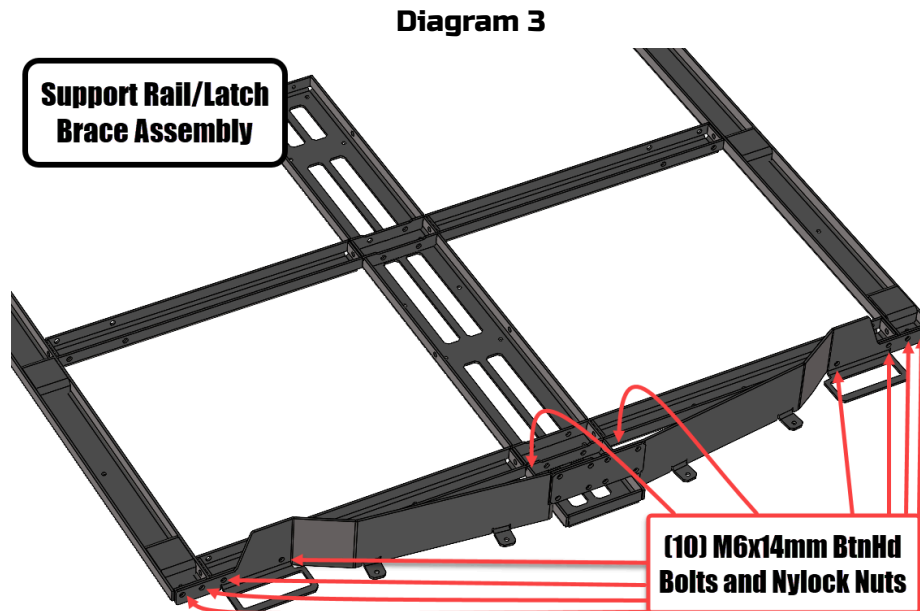


Next, we will assemble the Support Rail Assembly. On a flat surface, lay out the rail components as shown in diagram 2. **Note** - We will be assembling this portion upside down, so the driver's/passenger's side rails will be on opposite sides from where they will be in the vehicle.

Attach these components using (8) M6x14mm Button Head Bolts and Nylock nuts where shown with red arrows in diagram 2. Each support rail needs to be assembled in a particular orientation. The Side Support rails are designated with a "D" or "P" (cut into the top side of the part) for Driver and Passenger's sides. The Center Support rail must be assembled with the "hinge holes" on the same side as those in the Side Support rails. Finally, the Horizontal Support rails must be assembled positioning the ends with (2) holes in the flanges going outward. See diagram 2 for reference.



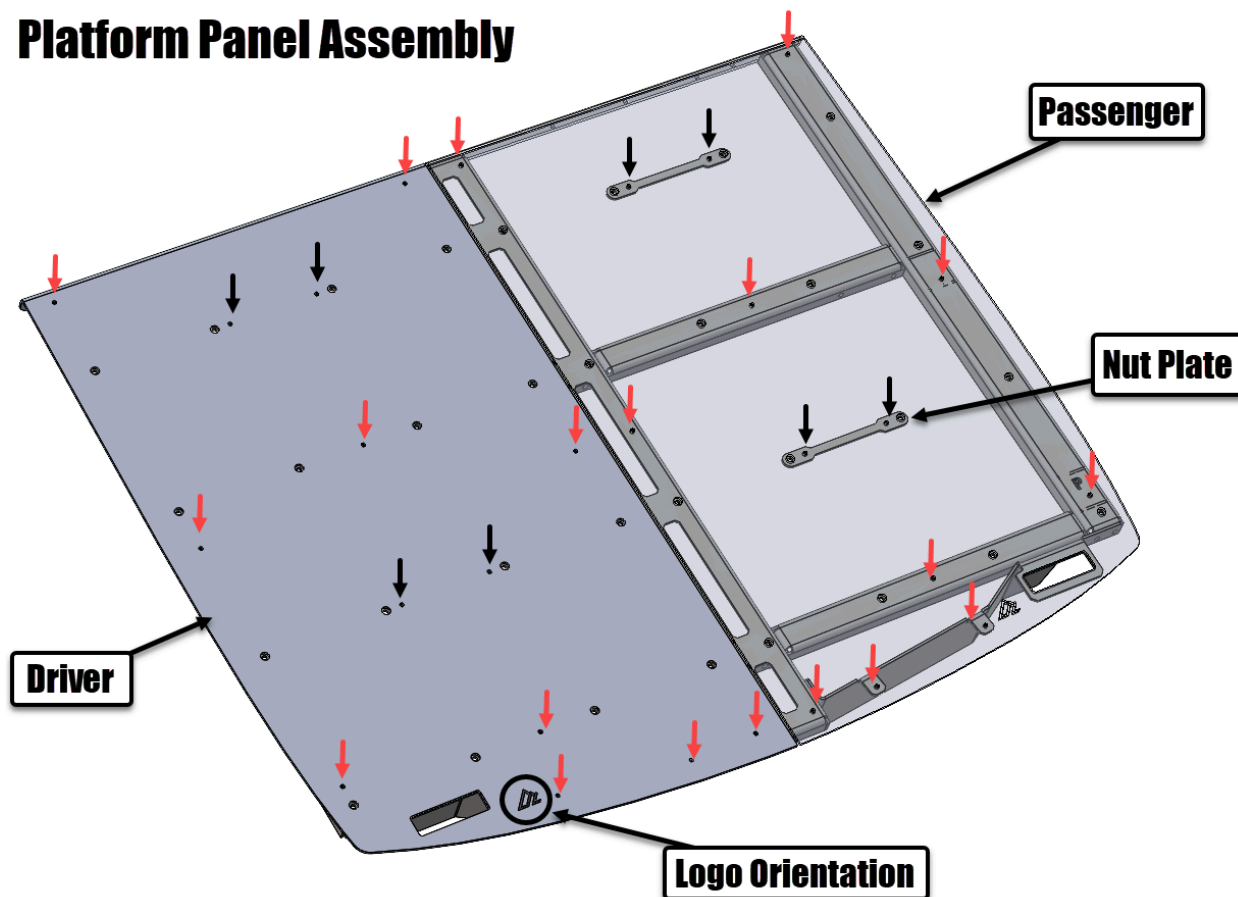
Now we will attach the Latch Brace Assembly to the Support Rail Assembly. To do so, orient them as shown in diagram 3, and attach with (10) M6x14mm Button Head bolts and Nylock nuts.



Lastly, we will attach the Platform Panels to the Support Rail Assembly using (20) M6x8mm Flat Head bolts, as well as attaching the Nut Plates to the Platform Panels with (8) M6x8mm Flat Head bolts. See diagram 4 for orientation of the Platform Panels and Nut Plates. The red arrows show Platform Panel attachment points, and the black arrows show that of the Nut Plates. *Note the orientation of the AAL logos in the bottom/outside corners of the platform panels. The image does not show the bolt locations as countersunk, but they will be on your platform panels.*

Diagram 4

Platform Panel Assembly



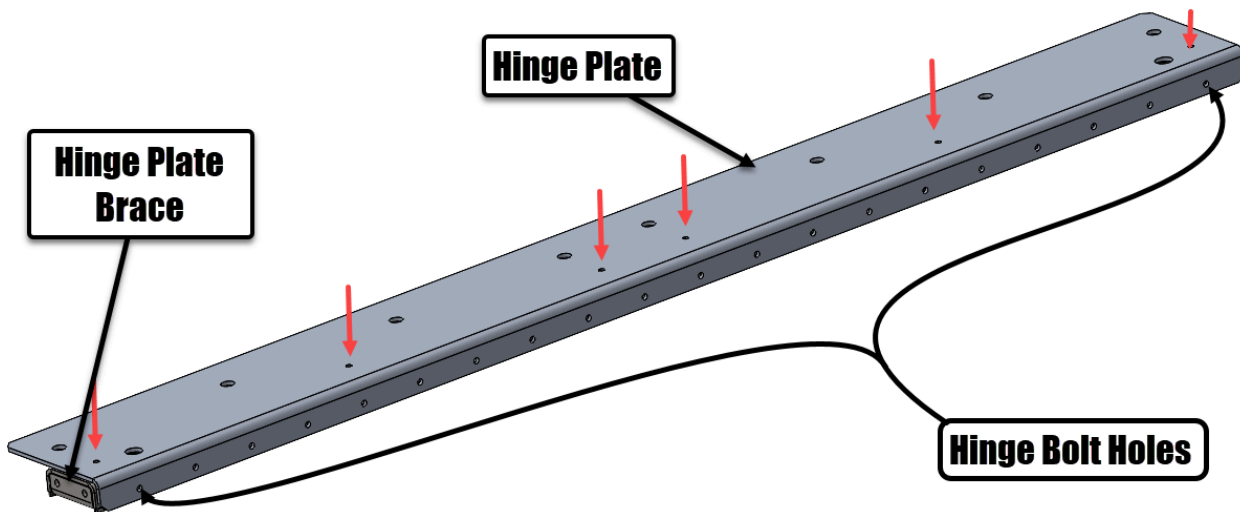
Step 4 - Hinge Plate Assembly

To assemble the Hinge Plate Assembly, locate the Piano Hinge, Hinge Plate, Hinge Plate Brace, (2) Vertical Supports, 90° Nut Plate, (4) M6x8mm Button Head bolts, (6) M6x8mm Flat Head bolts, (3) M6x14mm Button Head bolts, (3) M6 Nylock nuts, (12) M4x14mm Flat Head bolts, and (12) M4 Nylock nuts.

To begin, attach the Hinge Plate to the Hinge Plate Brace with (6) M6x8mm Flat Head bolts. These will go together much like the Platform Panels went onto the Rail Assembly. See diagram 5 for orientation. Bolt locations are shown with red arrows. *The image does not show the bolt locations as countersunk, but they will be on your platform panels.*

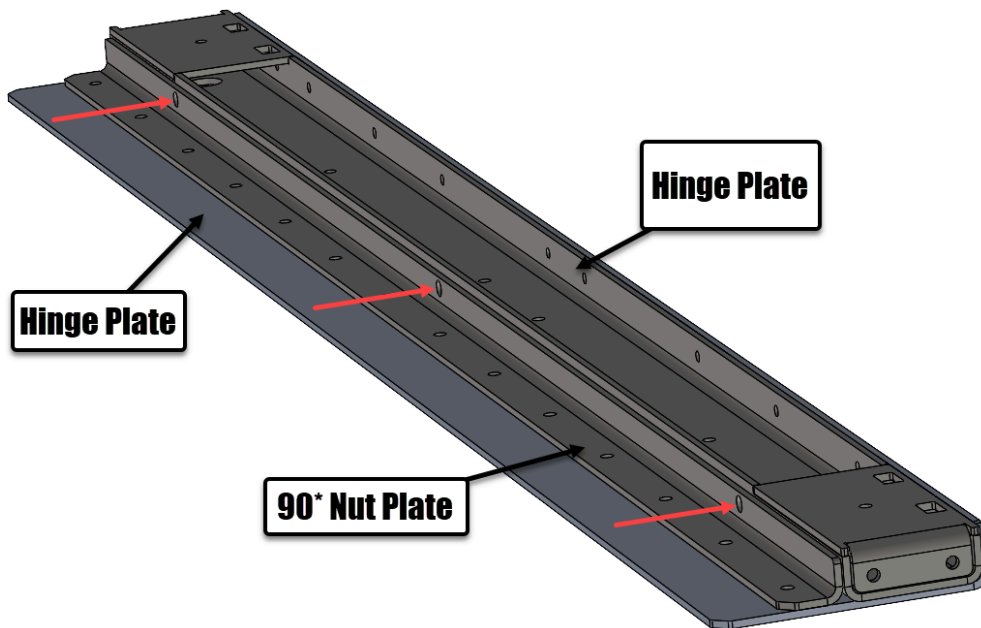


Diagram 5



Next, attach the 90° Nut Plate using (3) M6x14mm Button Head bolts and Nylock nuts. See diagram 6 for orientation. Bolt locations are shown with red arrows.

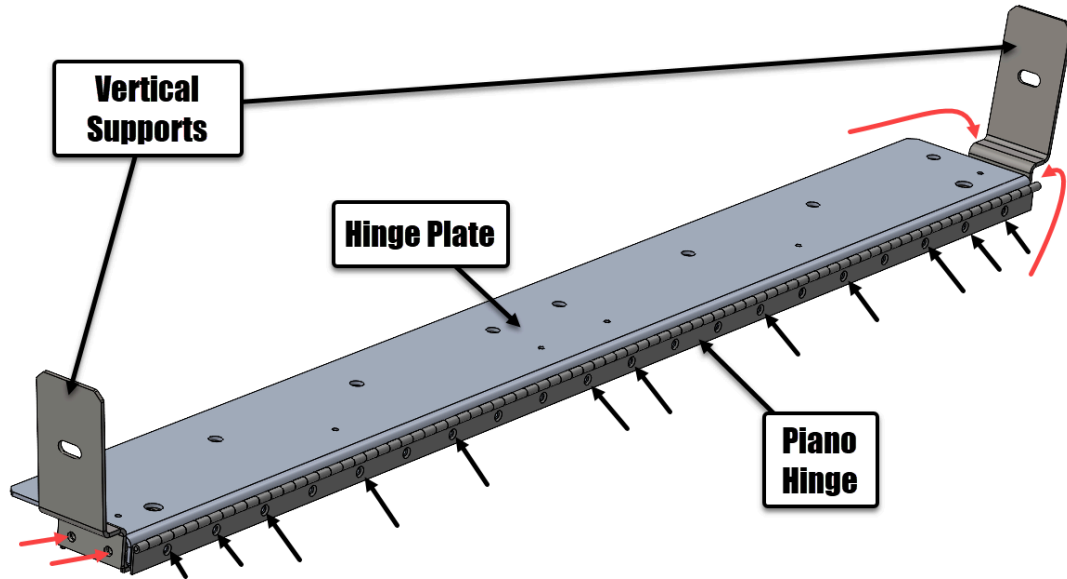
Diagram 6



Finally, install the Piano Hinge and Vertical Supports with (12) M4x14mm Flat Head bolts, (12) M4 Nylock nuts, and (4) M6x8mm Button Head bolts. See diagram 7 for orientation. M4 bolt locations shown with black arrows, and M6 bolt locations shown with red arrows.

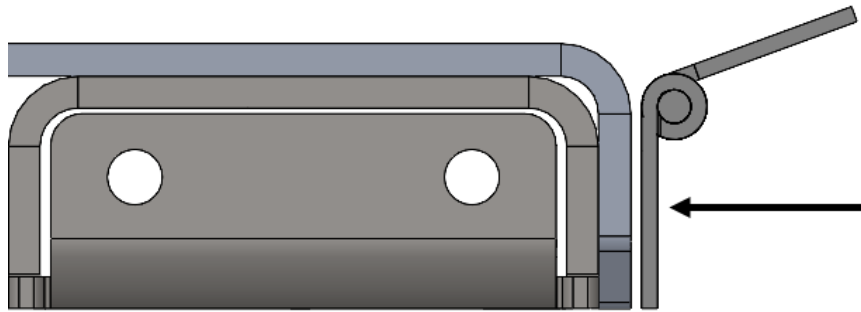


Diagram 6



****Hinge Note - See diagram 7 for hinge mounting orientation. Bolts should be installed from the direction shown with a black arrow.****

Diagram 7

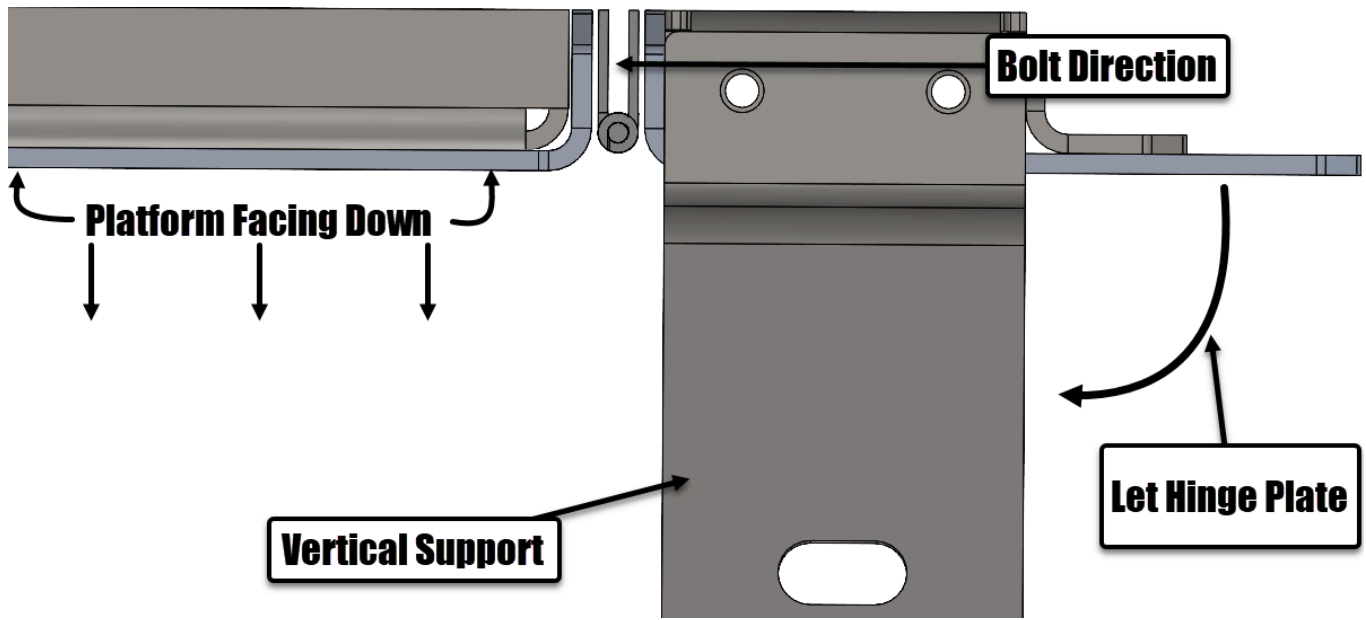


Step 5: Joining Hinge Plate & Platform Assemblies

The final step of preassembly is to join the two assemblies we've just created, the Hinge Plate assembly and Platform assembly, using (12) M4x14mm Flat Head bolts, and nylock nuts. This step is much easier with an extra set of hands. The way we do it, is to lay the platform upside down on a table, with the hinge side hanging off so the Hinge Plate assembly can be perpendicular to the platform, allowing access to the bolt locations. The (12) M4x14mm Flat Head bolts will go in with the same spacing and orientation as with the hinge attachment to the Hinge Plate assembly performed in the last step. See diagram 8 for reference.



Diagram 8



Go around and tighten all hardware, and you are done assembling the platform!

Step 6: Installing the Platform

Finally, we're ready to install the Platform assembly into your WL! Before doing so, install the (2) M8 Hex Stand Offs into the factory cargo tie down locations as shown in image 4.

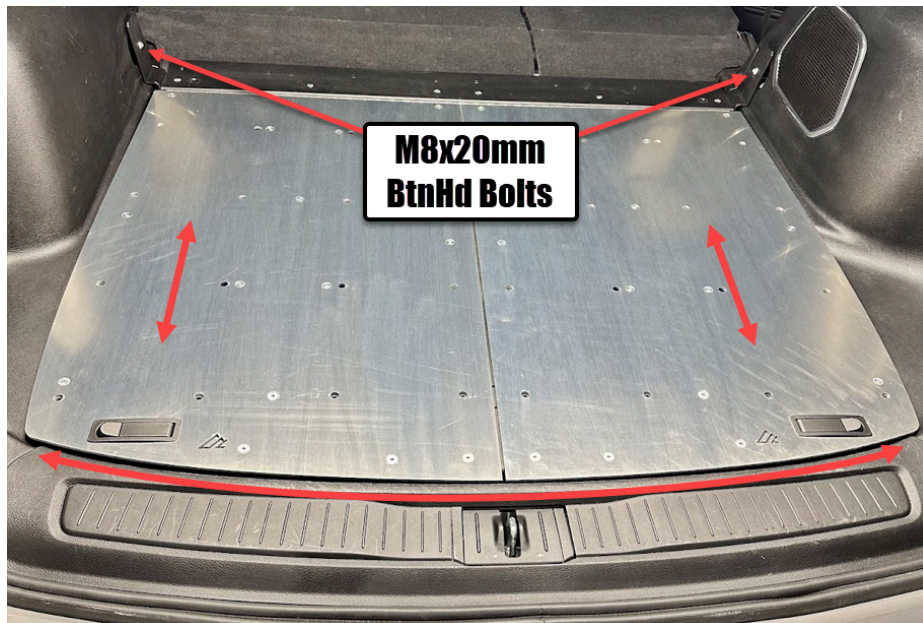
We strongly recommend using some medium strength threadlocker on the Hex Stand Offs.

Image 4



Now the fun part! With the help of a friend, bring the Platform assembly into the WL through the back hatch, Hinge Plate forward. The Vertical Supports should line up with the threaded side of the Hex Stand Offs. Loosely install an M8x20mm Button Head bolt into each side. The next thing you'll want to do is set the appropriate clearance along the back edge of the platform by adjusting the assembly front/rear. Shown in image 5.

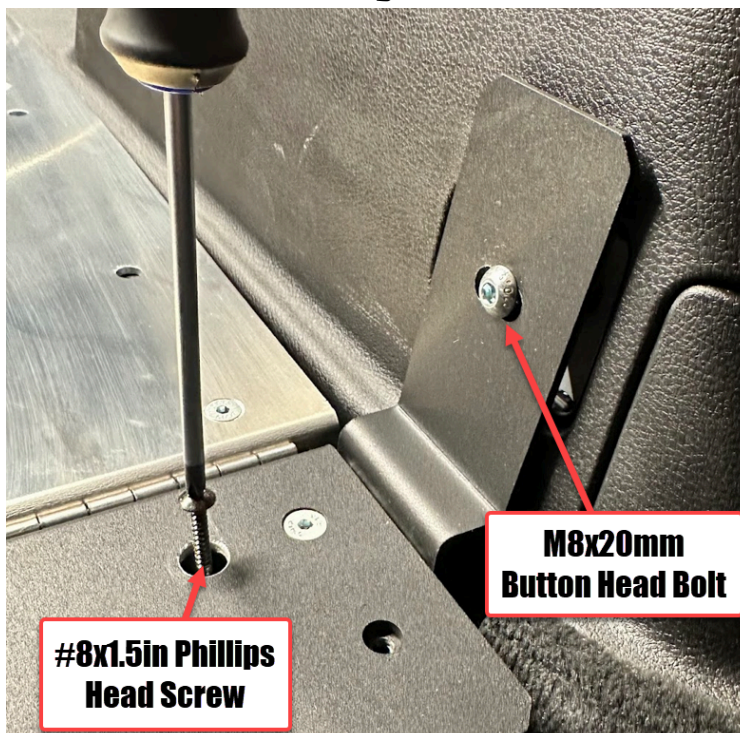
Image 5



Once adjusted, snug the (2) M8x20mm Button Head bolts, lift the rear edge of the platform assembly to make sure everything clears throughout operation. If anything hits, simply adjust the platform forward more. Once everything has been verified to clear, install and tighten the (2) #8x1.5in phillips head screws in the locations shown in image 6. You can also final tighten the M8x20mm Button Head bolts.

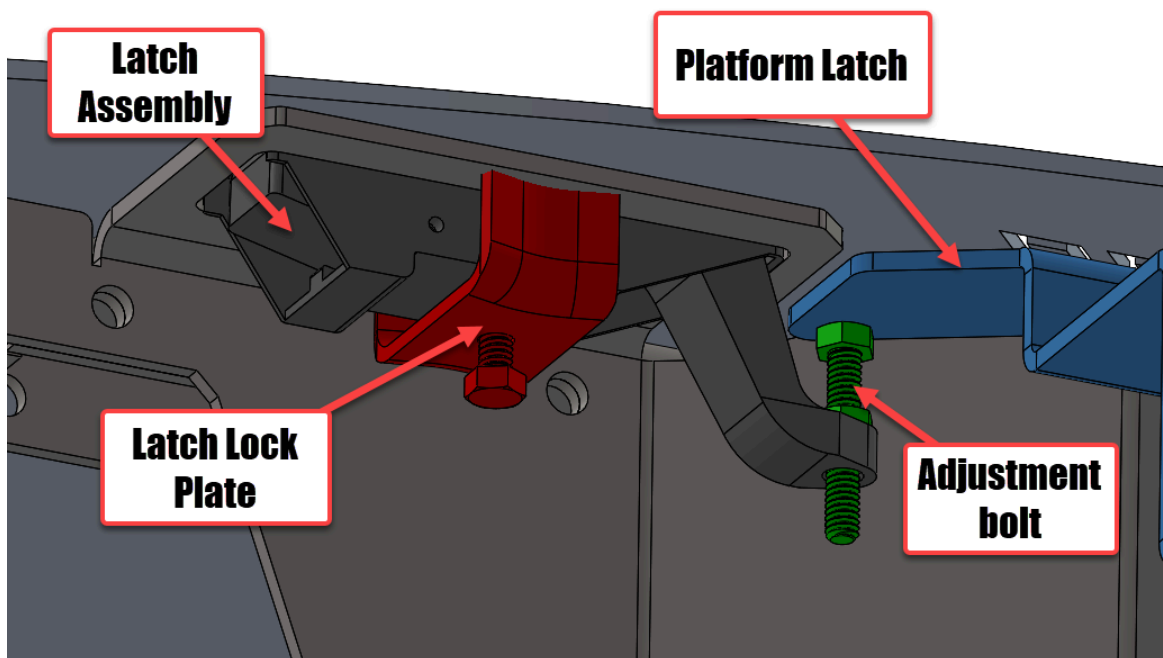
We strongly recommend using some medium strength threadlocker on the M8 bolts.

Image 6



The last and final step is to install and adjust the latches. To do so, remove the bolt and lock plate (shown in red in diagram 9) from the latch assembly. Install the assembly into the platform from the top side. See diagram 9 for orientation. Reinstall the lock plate and bolt and tighten with an 8mm wrench. Repeat for both sides. When installed, they should look as they do in image 5 and diagram 9.

Diagram 9



Once latches are installed, close and latch the platform. Pull up on the outside edge of the platform nearest each latch, and adjust the latch adjustment bolt (Shown in green in diagram 9) until there is little or no up/down movement from the platform. Once adjusted properly, snug the adjustment bolt jam nut with a 10mm wrench. Perform one last operational clearance check, and adjust as necessary.

Step 7: Share Your Photos

We take great pride in building our products and we hope that pride extends to you after installing your Jeep WL MASS Storage Platform. If you are able to share your photos online (Facebook and Instagram), please tag **@AmericanAdventureLab**. We would love to see how it turned out and give you some reciprocal attention in return!

Congrats! You're all done!

Thank you!!!

At American Adventure Lab, we strive to improve anywhere we can. If you experience any issues with this product or have any suggestions, please let us know.

If you have any questions or concerns, please don't hesitate to reach out to us at 385.202.4188 or via email at Support@erp.adventurelab.com.



